

SPACES	Reception (people)	Surface (square meters)	Surface (square feet)
110a	Place Riopelle South Hall	—	—
110b	Place Riopelle Hall	1,019	974
110c	Place Riopelle Hall North	—	—
110d	Lipstick Forest	753	700
110e	Palais Westside Passageway	727	675
110f	Jeanne-Mance Entrance	—	—
110g	Admission Area	568	528
110h	Westside Rest Area	165	153
110i	Eastside Rest Area	165	153
110j	Palais Central Passageway	547	508
110k	Jeanne-Mance Passageway	—	—
110l	Saint-François-Xavier Passageway	—	—
110m	Palais Eastside Passageway	—	—
110n	Viger Entrance	333	309
TERMV	Viger Terminal	875	813
TOTAL		4,813	51,805

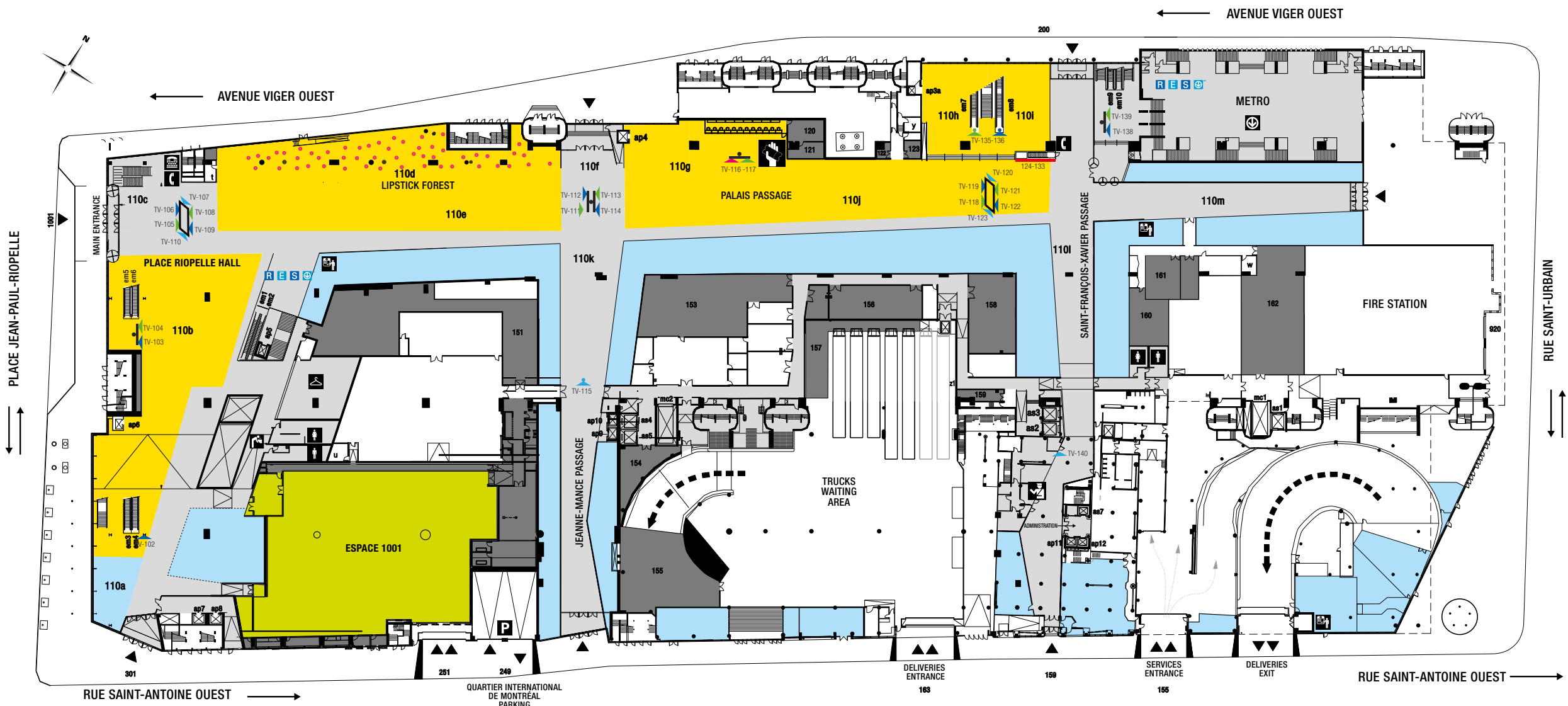
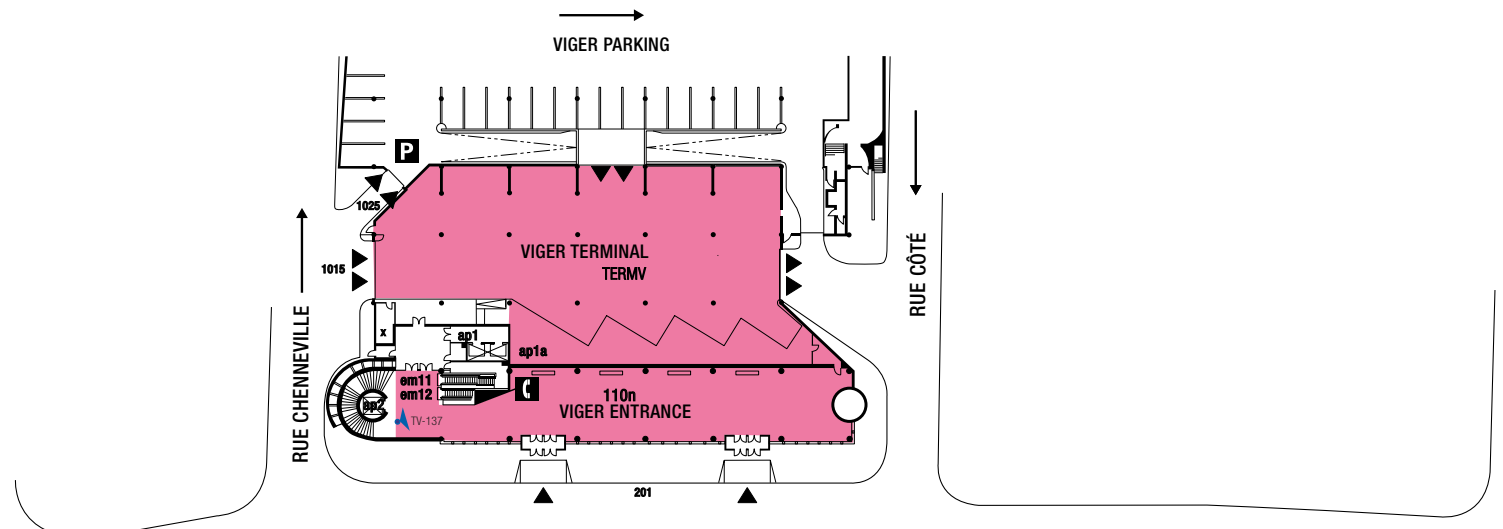

Level 1

- legend**
- Men's washroom
 - Women's washroom
 - Security SOC
 - Place-d'Armes metro station
 - Cloakroom
 - Telephone
 - Teletypewriter (TDD)
 - Ticket stand
 - Automatic teller
 - Water fountains
 - Parking
 - Pedestrian access
 - Vehicle access
 - ap: Public elevator
 - as: Service elevator
 - mc: Freight elevator
 - em: Escalator
 - Les Galeries du Palais
 - Public areas / Rental Space
 - Public areas
 - Rental Space - Optional
 - Exclusive use
 - Espace 1001
 - R E S C Indoor Pedestrian Network

DIGITAL DISPLAYS

Group	Description	Total
Group 1	« Cette semaine au Palais »	6
Group 2	« Aujourd'hui au Palais »	11
Group 3	External advertisers screens	10
Group 6	Ticketing screen	1
Group 7	Video wall	1

Note: Maximum capacities vary according to current regulations, room configuration and type of event, and should be interpreted on that basis as well as the total evacuation capacity per building level. Said capacities may differ when events are held simultaneously and if audiovisual considerations have to be factored in. Please note the figures are for information purposes and are subject to change without notice.