

Mezzanine 4

ESPACES	Conférence (personnes)	Réception (personnes)	Largeur (mètres)	Longueur (mètres)	Hauteur (mètres)	Largeur (pi-po)	Longueur (pi-po)	Hauteur (pi-po)	Superficie (mètres carrés)	Superficie (pieds carrés)
Salles de conférence										
440	16	–	4,2	7,8	2,4	13-10	25-5	8	33	351
441	16	–	4,3	7,8	2,4	14-2	25-5	8	34	360
445b	16	–	5,1	9,2	2,7	16-8	30-2	9	46	489
447	16	–	7,7	8,8	2,7	25-1	28-10	8-9	70	749
448	16	–	4,8	8,9	2,7	15-8	29-2	8-9	42	455
Salons										
445a	–	45	6,1	6,7	2,7	20	22-7	9	46	492
446	–	45	6,1	6,7	2,7	20	22-7	9	46	492
449	–	35	5,7	6,1	2,4	18-7	19-10	9-8	35	378

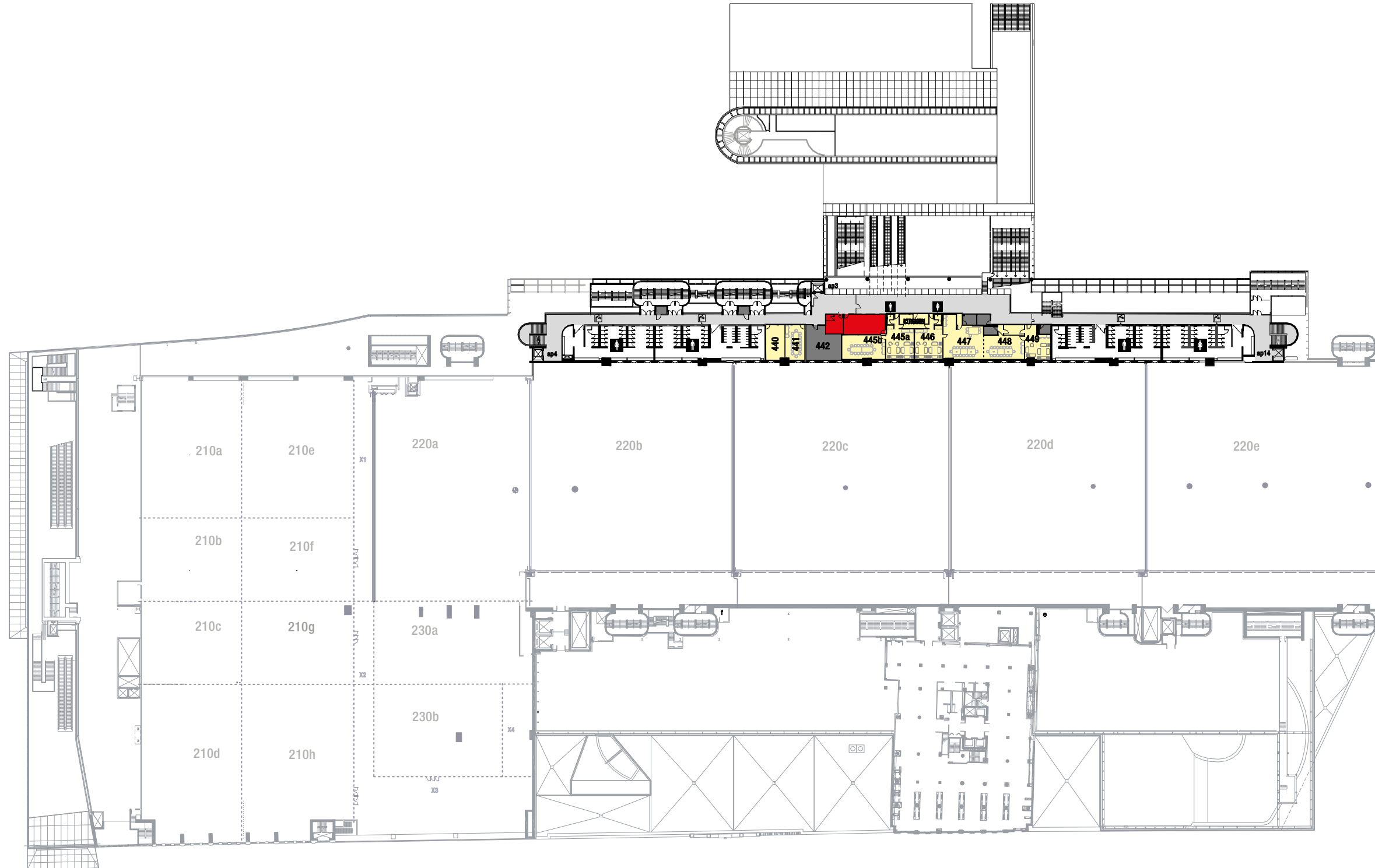

Mezzanine 4

legend

- ap : Public elevator
- Yellow square: Rental space
- Grey square: Exclusive use
- Light grey square: Common areas
- Red square: VIP room

Note: Maximum capacities vary according to current regulations, room configuration and type of event, and should be interpreted on that basis as well as the total evacuation capacity per building level. Said capacities may differ when events are held simultaneously and if audiovisual considerations have to be factored in. Please note the figures are for information purposes and are subject to change without notice.