

ESPACES	Theater (people)	Banquet (10 people/table)	Classroom (3 people/table)	Reception (people)	Stand (10 x 10)
210abcdefgh	6,513	3,240	4,140	5,050	240
210a	792	420	570	743	35
210b	448	250	288	435	21
210c	448	250	288	435	21
210d	825	420	570	821	38
210e	936	420	627	808	41
210f	551	300	336	475	22
210g	551	300	336	475	22
210h	897	480	591	853	41
210 Prefunction West	-	-	-	903	23
210 Prefunction North	-	-	-	434	7
220abcde	12,143	6,820	8,701	12,696	603
220a	1,800	1,120	1,420	1,726	82
220b	2,514	1,380	1,680	2,629	125
220c	2,622	1,440	1,857	2,776	132
220d	2,287	1,360	1,692	2,541	121
220e	2,920	1,520	2,052	3,024	144
220 Prefunction	-	-	-	1,421	30
230a	554	240	324	626	31
230b	569	250	324	604	29
210-220-230 X1 X2 X3 X4	-	13,860	-	13,863	954
Viger Hall	-	-	-	902	40
Extensions					
X1	-	-	-	-	-
X2	-	-	-	-	-
X3	-	-	-	-	-
X4	-	-	-	-	-
Outdoors					
Esplanade and Garden	-	-	-	-	-
Esplanade	-	-	-	904	-
Esplanade Terrace	-	-	-	84	-
Total maximum capacity	13,863	13,860	13,863	13,863	1,054

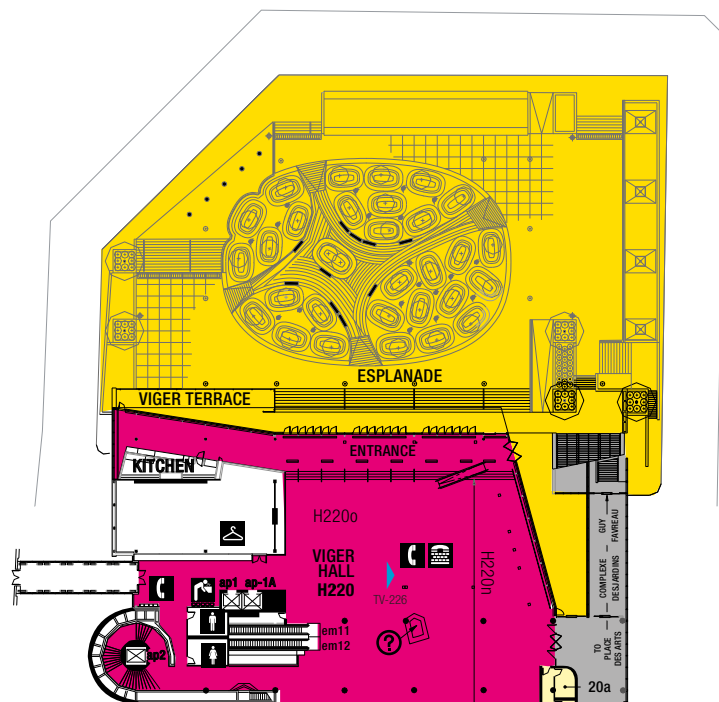

Width (meters)	Length (meters)	Height (meters)	Width (feet)	Length (feet)	Height (feet)	Surface (square meters)	Surface (square feet)
99.8	46.6	9.2	327' 3"	152' 9"	30'	4,666	50,228
30.7	22.3	9.2	100' 10"	73'	30'	684	7,363
17.9	22.3	9.2	58' 10"	73'	30'	399	4,296
17.9	22.3	9.2	58' 10"	73'	30'	399	4,296
33	22.3	9.2	108' 1"	73'	30'	734	7,897
32.7	24.2	9.2	100' 10"	79' 6"	30'	791	8,514
17.9	24.2	9.2	58' 10"	79' 6"	30'	434	4,674
17.9	24.2	9.2	58' 10"	79' 6"	30'	434	4,674
32.7	24.2	9.2	107' 2"	79' 6"	30'	791	8,514
-	-	-	-	-	-	839	9,029
-	-	-	-	-	-	403	4,335
220.8	48 and 54	9.7	724' 5"	177' 1"	31' 9"	11,676	125,717
33.8	48	9.7	110' 11"	157' 6"	31' 9"	1,587	17,088
45	54	9.7	147' 7"	177' 1"	31' 9"	2,418	26,036
47	54	9.7	154' 2"	177' 1"	31' 9"	2,553	27,480
43	54	9.7	141' 1"	177' 1"	31' 9"	2,337	25,165
52	54	9.7	170' 4"	177' 1"	31' 9"	2,781	29,948
-	-	-	-	-	-	1,321	14,212
32	18	9.2	105'	59'	30'	597	6,426
27.8	20	9.2	91' 1"	65' 7"	30'	553	5,961
-	-	9.2	-	-	30'	18,493	199,052
-	-	-	-	-	-	838	9,016
Subtotal							
4.3	48	9.2	14' 1"	157' 6"	30'	206	2,219
4.3	18	9	14' 1"	59'	29' 5"	77	838
4.3 and 36.8	34.4 and 14.5	9	14' 1" and 120' 8"	112' 11" and 47' 6"	29' 5"	605	6,517
4.6	20	9	15'	65' 7"	29' 5"	107	1,146
Subtotal							
-	-	-	-	-	-	1,992	21,440
-	-	-	-	-	-	840	9,041
-	-	-	-	-	-	78	836
Total							
						22,810	245,521

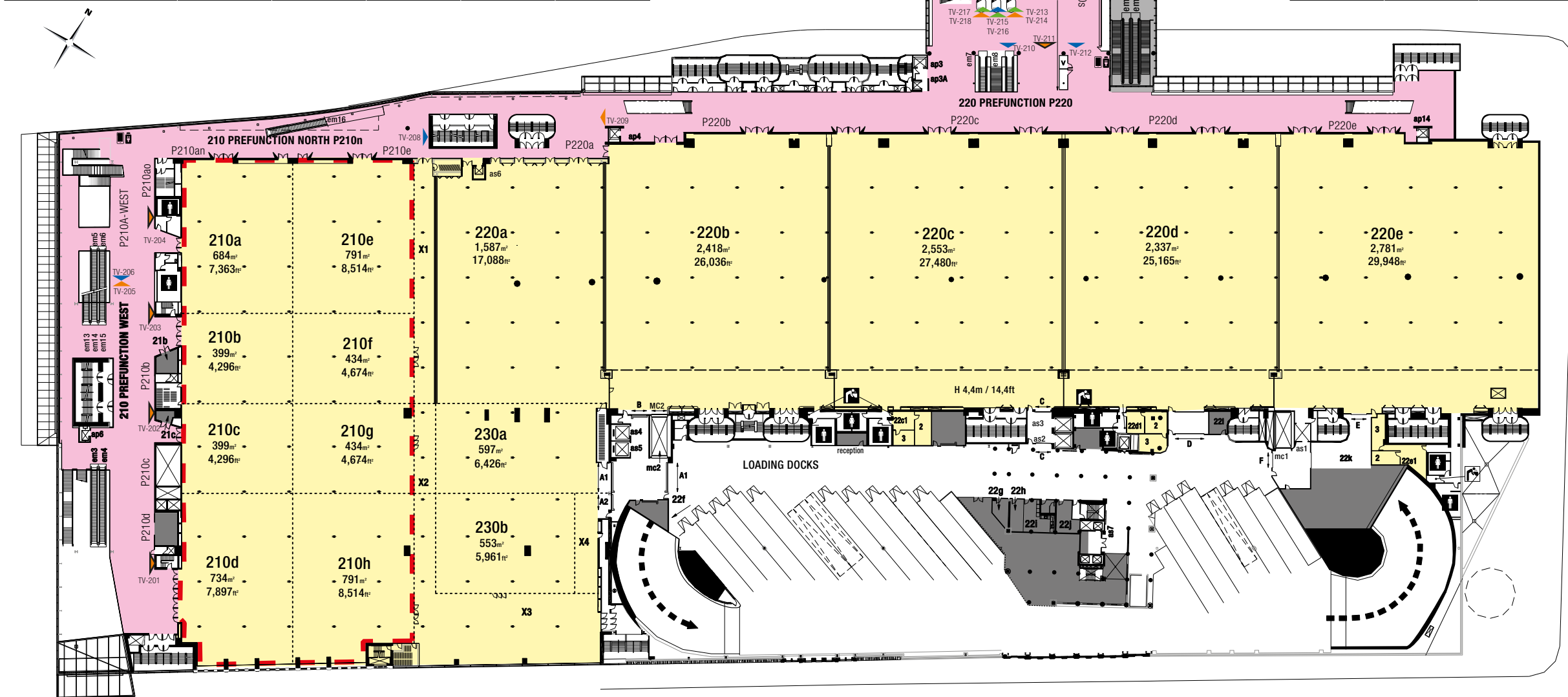

Level 2

Legend

	Men's washroom		Public areas / Rental Space
	Women's washroom		Public areas / Rental Space - Optional
	Information		Common areas / Rental Space - Optional
	Cloakroom		Rental Space
	Telephone		Ballroom
	Teletypewriter (TDD)		Public areas
	Water fountains		Exclusive use
	Floor services		mc : Freight elevator
	Drop wall		em : Escalator
	Rail		
	ap : Public elevator		
	as : Service elevator		

DIGITAL DISPLAYS

	Group 1	"Cette semaine au Palais" screens	Total
	Group 2	"Aujourd'hui au Palais" screens	1
	Group 3	External advertisers screens	8
	Group 4	Rental service screens (Palais services)	3
	Group 5	Rental service screens (Palais services) and "Dans cet espace" (screens in room)	12*
			5

*including Group 5

Note: Maximum capacities vary according to current regulations, room configuration and type of event, and should be interpreted on that basis as well as the total evacuation capacity per building level. Said capacities may differ when events are held simultaneously and if audiovisual considerations have to be factored in. Please note the figures are for information purposes and are subject to change without notice.

April 2019

Palais des congrès de Montréal